

LORDS OF THE RING TAJFUN VILLAGE - INDUSTRIAL COMPLEX

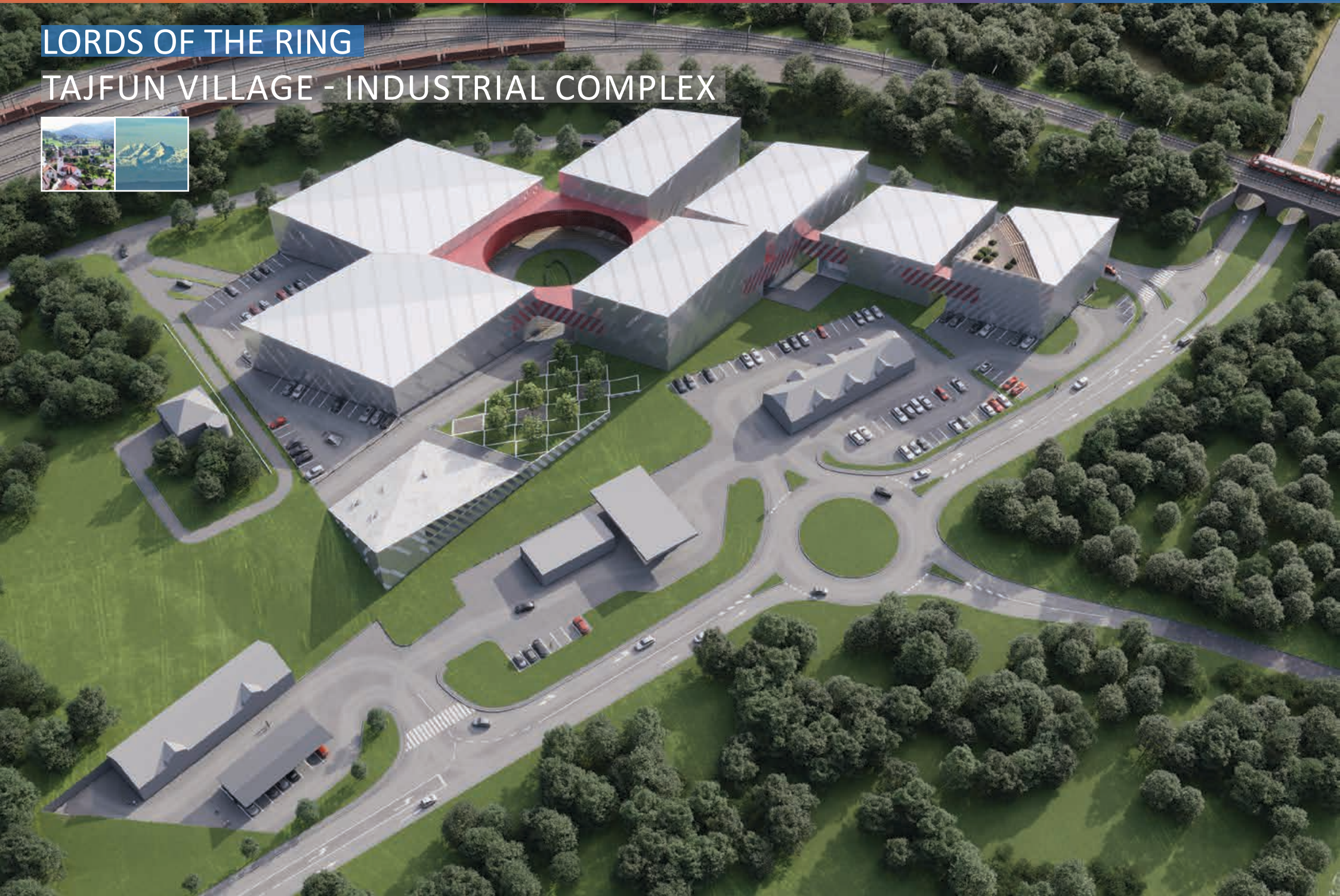

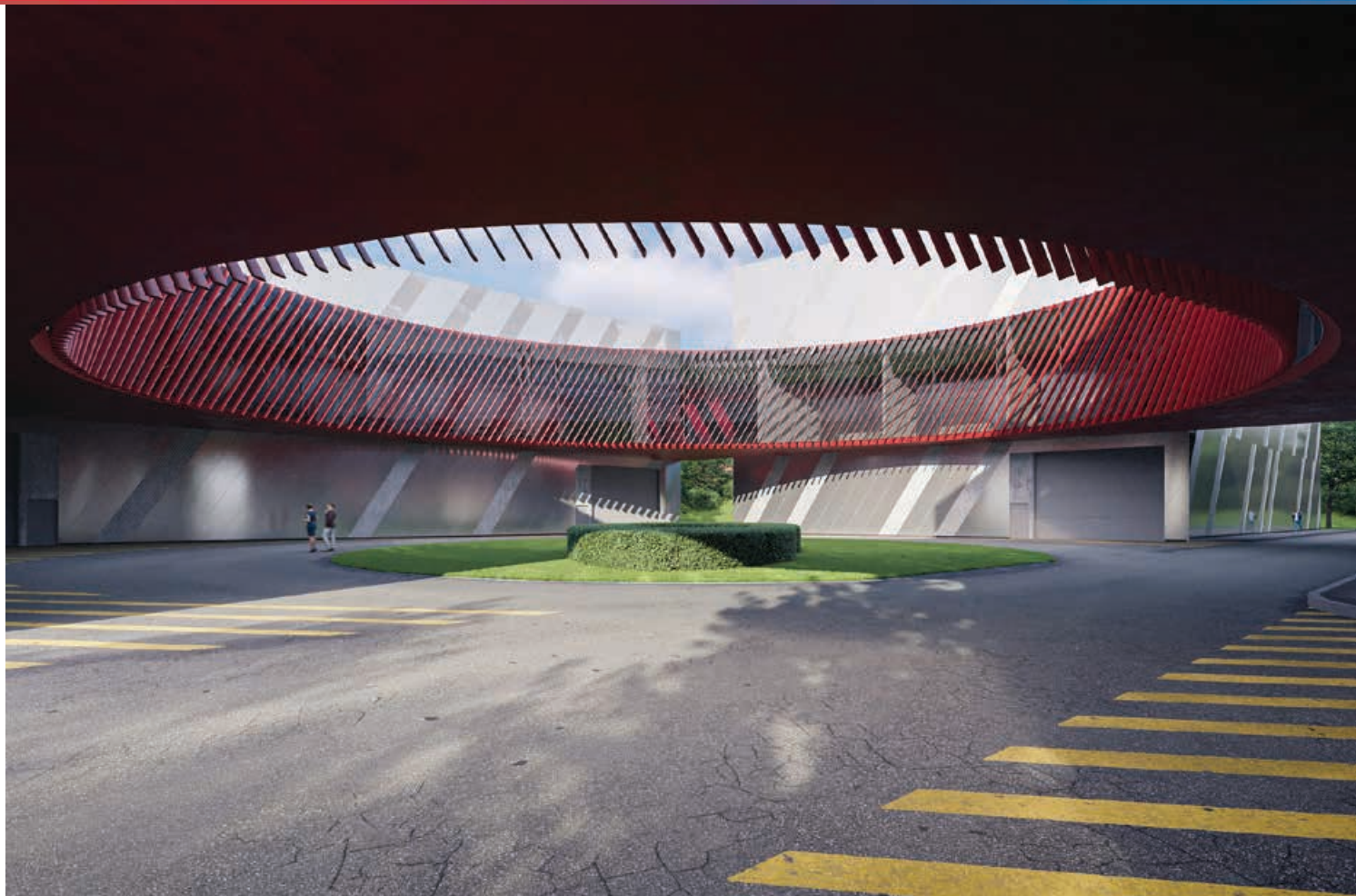
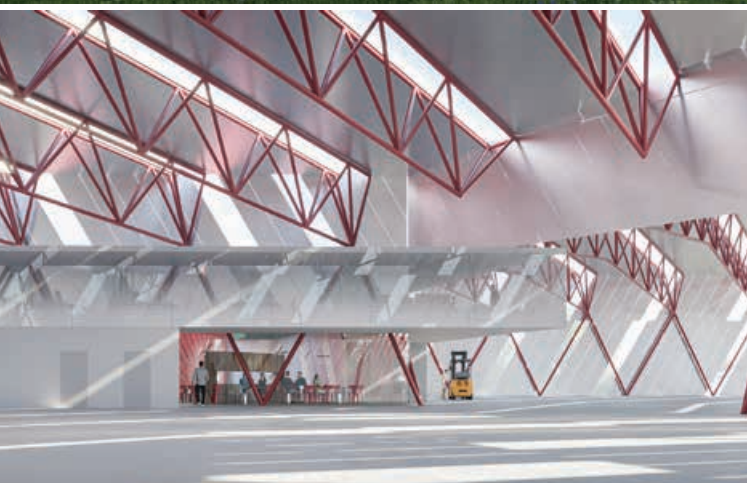

The architecture of the Tajfun Village complex is structured in the form of a clustered village. The whole image of buildings with pointed roof tips, together with the metal-glass envelope of the buildings, recreates the image of the "ice" mountains and creates an experience of the Alpine world. The diffusely reflex surface of the façade reflects the image of the surroundings on its surface, and in this way subtly integrates into the space. The project creates an experience based on the identity of the client and the space where we experience the village and the mountains. It is experience we can feel it or we simply enjoy and work in it.

Code name:	Lords of the Ring
Program:	Industry
Type:	Commision
Year:	2020
Client:	Tajfun Planina d.o.o.
Location:	Postojna, Slovenia
Area:	33.000m2
Architects:	Superform: Marjan Pobljšaj, Anton Žižek, Špela Gliha
Renderings:	Goran Djokić